



## Customizable Key Holder

 Justin

[VIEW IN BROWSER](#)

updated 12. 4. 2022 | published 1. 4. 2022

### Summary

A two color key holder that can be used as is or after customizing the inserts. (the red part in the image)

[Household](#) > [Office](#)

Tags: [holder](#) [customizable](#) [keychain](#) [key](#) [keys](#)

[Update: 01/04/2022]: Added to this site.

[Update: 28/02/2022]: Fixed an issue with the plain insert

[Update: 19/02/2022]: added hex pattern and fixed issue with clearance.

### Customizable Key Holder

While I was browsing older files on thingiverse, I found the Proteus Key Holder by ProteanMan. I decided that I wanted to make my own with a few extra features.

### Files to Download

You will have to download the Base Key Holder file and either the Solid Key Holder or the Hex Key Holder file.

On top of that, you can download the spacer file, it's optional but it is provided. Also, you may require different size spacers then the ones I provided, in that case either scale a provided spacer on the z axis in the slicer to the required height or create your own.

## Printing

Print flat on the bed with fairly high infill for better strength.

Depending on the orientation of the inserts, support may be needed. Double check the holes in the inserts are properly supported before printing.

The one I printed was made with PolyLite Black PETG and PolyTerra Army Red PLA

## Parts

- 3 x M3x(KeyThickness+SpacerThickness+7mm)
- 3 x M3 nut

## Assembly

Print out all the parts and spacers if desired and stack them together. Tighten the 3 screws, being careful to not overtighten the middle one and, if needed, smooth the edges.

## Designs

Feel free to take the insert parts and add your own design to them, that was the point of having them in the first place.

Design was made in solidworks, the part files for the inserts are included for easier editing if you have access to solidworks.

Category: Organization

## Model files



**Base Key Holder**

2 files



**basehex.stl**



**basescrew.stl**



**Solid Key Holder**

2 files



**inserthex.stl**



**insertscrew.stl**



**Hex Key Holder**

2 files



**insertscrew\_hex.stl**



**inserthex\_hex.stl**



**Solidworks parts**

2 files



**inserthex.sldprt**



**insertscrew.sldprt**



**Spacers**

3 files



**55mm\_spacer.stl**

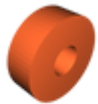

**34mm\_spacer.stl**



**spacer\_1mm.stl**

[Find source .stl files on Thingiverse.com](#)

## License

This work is licensed under a  
**Creative Commons (4.0 International License)**



### **Attribution**

- ✗ | Sharing without ATTRIBUTION
- ✓ | Remix Culture allowed
- ✓ | Commercial Use
- ✓ | Free Cultural Works
- ✓ | Meets Open Definition

